

## 101 OLD PARK ROAD

LEEDS, LS8 1DG

£1,000,000  
FREEHOLD

Monroe is delighted to present Old Park House, located at 101 Old Park Road. Situated in the heart of Roundhay, this impressive detached home has been impeccably cared for by its current owners and boasts an expansive 2,760 square feet of living space.

MONROE

SELLERS OF THE FINEST HOMES



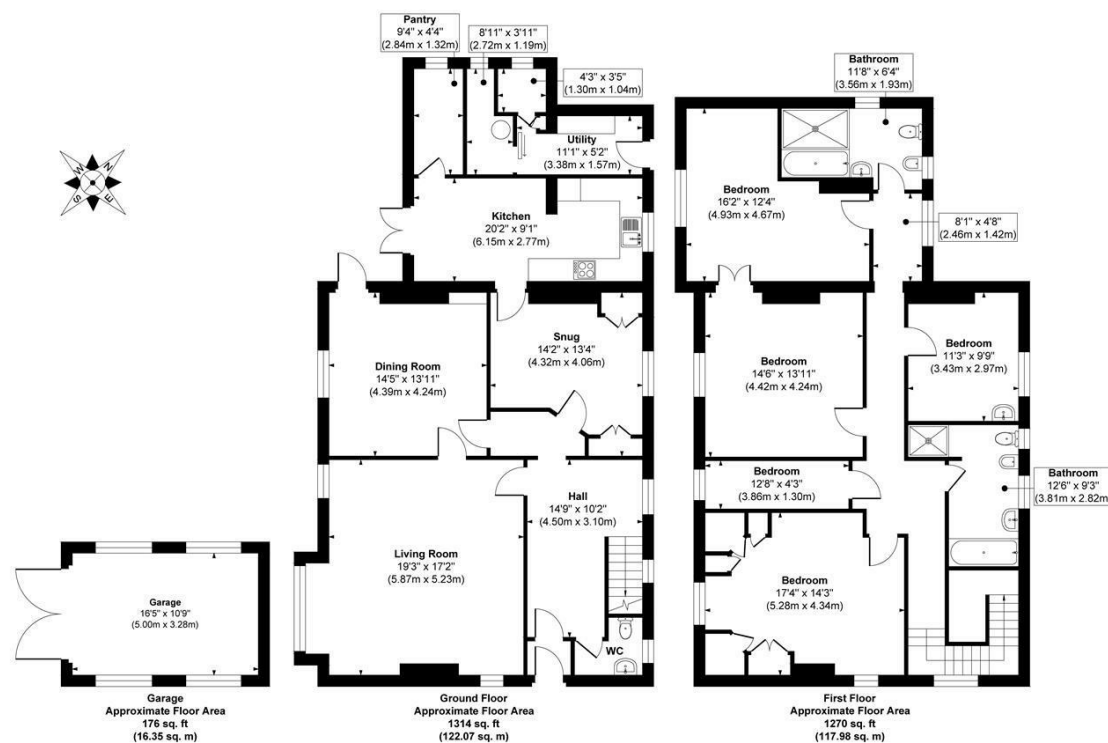

Approx. Gross Internal Floor Area 2760 sq. ft / 256.40 sq. m

Illustration for identification purposes only. measurements are approximate, not to scale.

Copyright © Zenith Creations.

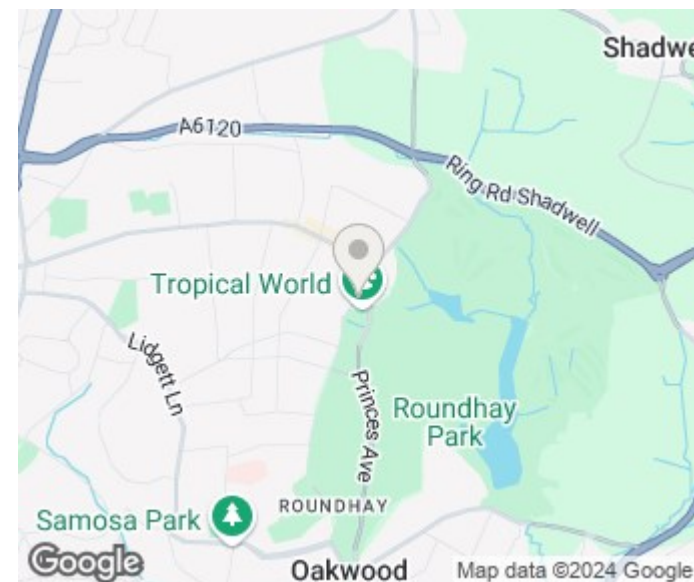

Energy Efficiency Rating		
	Current	Potential
Very energy efficient - lower running costs		
(92 plus) <b>A</b>		
(81-91) <b>B</b>		
(69-80) <b>C</b>		
(55-68) <b>D</b>		
(39-54) <b>E</b>		
(21-38) <b>F</b>		
(1-20) <b>G</b>		
Not energy efficient - higher running costs		
<b>England &amp; Wales</b>	EU Directive 2002/91/EC	

Agents Note: Whilst every care has been taken to prepare these particulars, they are for guidance purposes only. All measurements are approximate and are for general guidance purposes only and whilst every care has been taken to ensure their accuracy, they should not be relied upon and potential buyers/tenants are advised to recheck the measurements

Alwoodley Sales  
1-3 The Avenue  
Alwoodley  
Leeds  
West Yorkshire  
LS17 7BD

0113 870 4443  
hello@monroeestateagents.com  
www.monroeestateagents.com

MONROE

SELLERS OF THE FINEST HOMES